

A

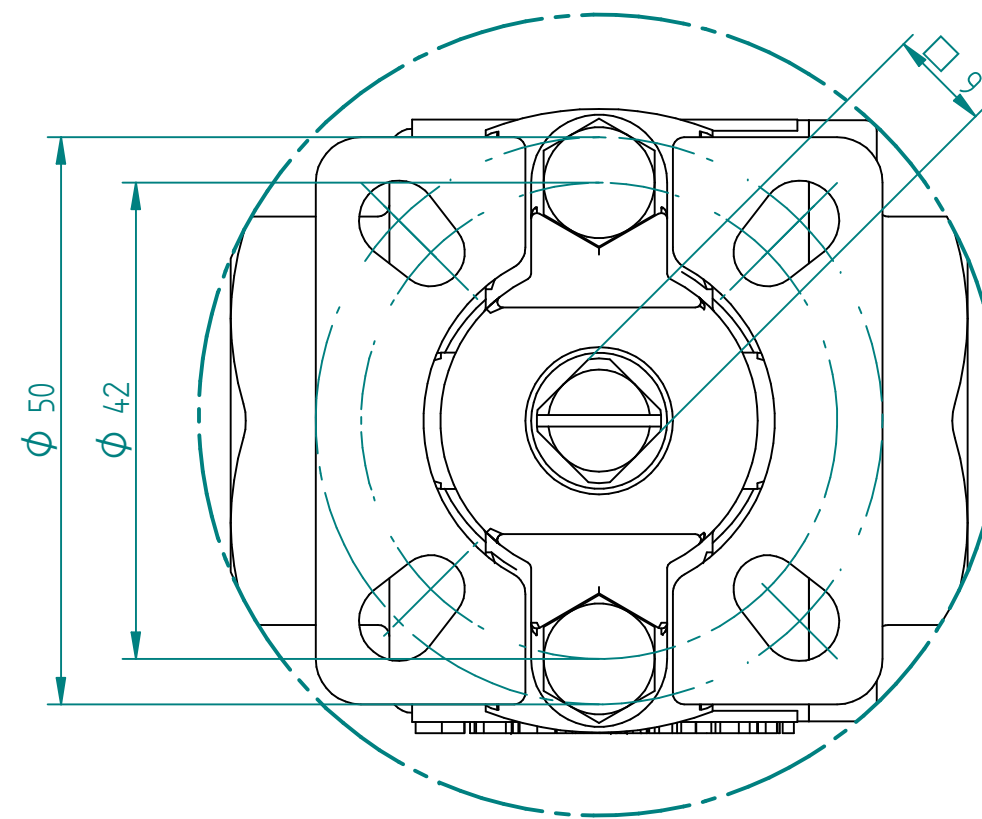

DETAIL A
ISO 5211 Mounting Pad
1.5:1

POS	Item Number	Description
1	Body	ASTM A351 CF8M
2	Bonnet	ASTM A351 CF8M
3	Ball	Stainless steel (SS316)
4	Stem	Stainless steel (SS316)
5	Seat	50% PTFE+SS316
6	Washer	PTFE
7	Gasket	PTFE
8	Stem packing	PTFE
9	Ring	SS316
10	Belleville washer	SS301
11	Gland flange	CF8
12	O-ring	Viton

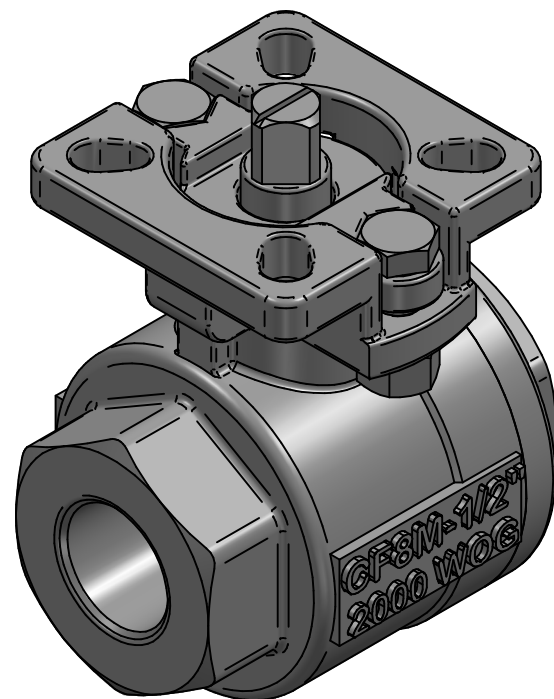

TITLE BALLVALVE V-PORT 60 DEG 1/2" BSP SS316
2PC, G2PQ11FV-2000-316, 9-F04/F05
2000WOG, V-BALL ,50/50 316/PTFE SEAT, 10 NM

	NAME	DATE	SIZE	DWG NO
DRAWN	MOTO	4/6/2020	A3	YON-100-BSP60-0015
CHECKED	ORLA	10/23/2023	FILE NAME: YON-100-BSP60-0015.dft	
ENG APPR	TOCO	dd.mm.yyyy	SCALE: 1:1	REV: 1.1
MGR APPR	TOCO	dd.mm.yyyy	WEIGHT:	SHEET: 1 OF 1

UNLESS OTHERWISE SPECIFIED
DIMENSIONS ARE IN MILLIMETERS
AND TOLERANCES ARE +/-0,5

REV	DESCRIPTION	DATE	APPROVED
REVISION HISTORY			