

B

NAMUR 1/4"

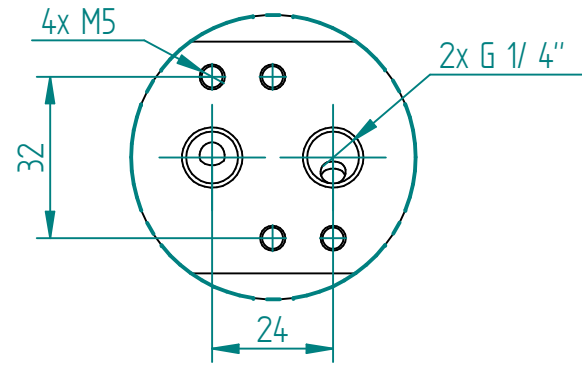

DETAIL A

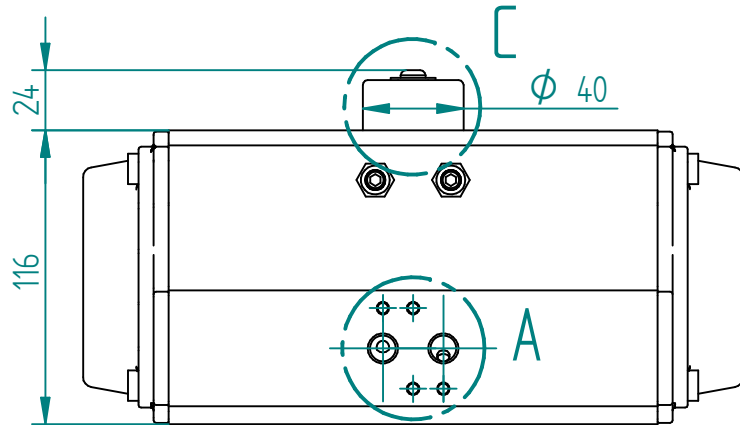

A

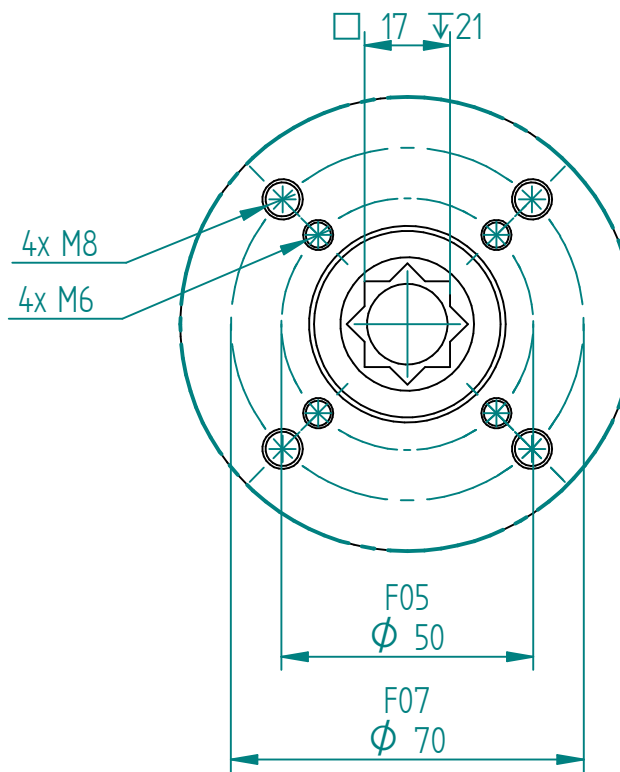
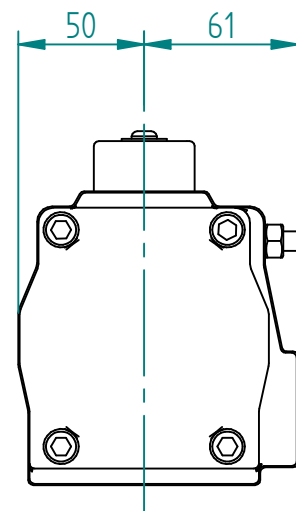

DETAIL B

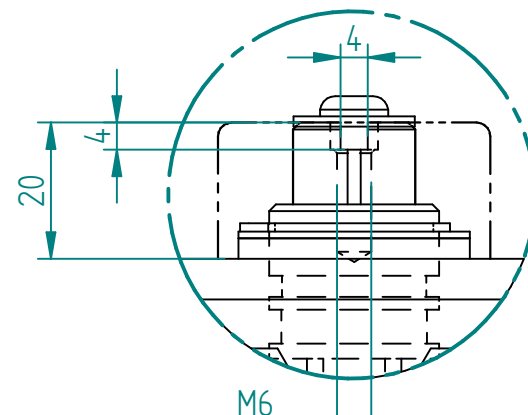
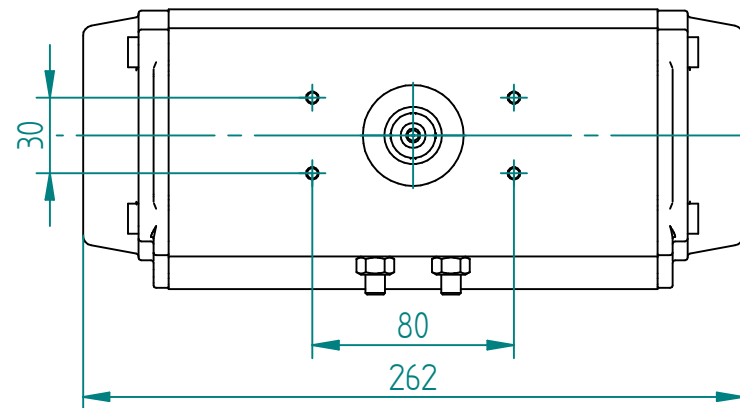

DETAIL C

| Pos | Part name                | Material    |
|-----|--------------------------|-------------|
| 1   | Indicator bolt           | 304         |
| 2   | Indicator                | ABS/304     |
| 3   | Circlip                  | 304         |
| 4   | Thrust washer            | 304         |
| 5   | Outside washer           | POM         |
| 6   | Body                     | Alu 6005-T5 |
| 7   | Piston guide             | POM         |
| 8   | O-ring (pinion top)      | NBR         |
| 9   | Bearing (pinion top)     | POM         |
| 10  | Inside wahser            | POM         |
| 11  | Cam                      | Steel #45   |
| 12  | Pinion                   | Steel #45   |
| 13  | Bearing (pinion bottom)  | POM         |
| 14  | O-ring (pinion bottom)   | NBR         |
| 15  | Bearing (piston)         | POM         |
| 16  | O-ring (piston)          | NBR         |
| 17  | Piston                   | Alu A380    |
| 18  | Plug                     | NBR         |
| 19  | O-ring (adjustment srew) | NBR         |
| 20  | Nut (adjustment srew)    | 304         |
| 21  | Adjustin srew            | 304         |
| 22  | Stop bolt                | 304         |
| 23  | Stop nut                 | 304         |
| 24  | O-ring (end cap)         | NBR         |
| 25  | End-cap                  | Alu A380    |
| 26  | End-cap screw            | 304         |

WWF / Venus dual acting actuator

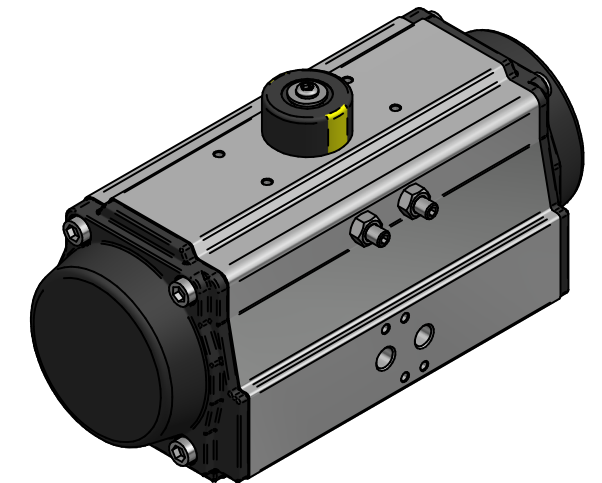

| DRAWN    | NAME | DATE       | SIZE                           | DWG NO          |
|----------|------|------------|--------------------------------|-----------------|
|          | EMLA | 08.04.2024 | A3                             | WWF-03VE092DA17 |
| CHECKED  | EMLA | 08.04.2024 | FILE NAME: WWF-03VE092DA17.dft |                 |
| ENG APPR |      |            | SCALE: 1:3                     | REV: 00         |
| MGR APPR |      |            | WEIGHT: 4.6 kg                 | SHEET: 1 OF 1   |

UNLESS OTHERWISE SPECIFIED DIMENSIONS ARE IN MILLIMETERS AND TOLERANCES ARE +/-0,5

| REV              | DESCRIPTION | DATE       | APPROVED |
|------------------|-------------|------------|----------|
| 00               | ISSUED      | 11.07.2024 | EMLA     |
| REVISION HISTORY |             |            |          |

TITLE VENUS 92 ACTUATOR DA F05/F07-SQ17X21  
BODY: ALU, NBR (-20 TIL 80°C)  
HARD ANODIZED, 135,4NM @ 6BARG