

DETAIL A 1:1

Hole pattern for solenoid valves acc. to VDI/VDE 3845, NAMUR

Function	Position 0°=closed 90°=open	2,1 bar 30 psi	2,8 bar 40 psi	3,5 bar 50 psi	4,2 bar 60 psi	4,5 bar 65 psi	5,5 bar 80 psi	6 bar 87 psi	7 bar 100 psi
Air	0°	13	17	21	25	27	35	38	44
Air	60°	6	8	10	12	13	17	19	22
Air	90°	9	12	15	18	19	25	27	32

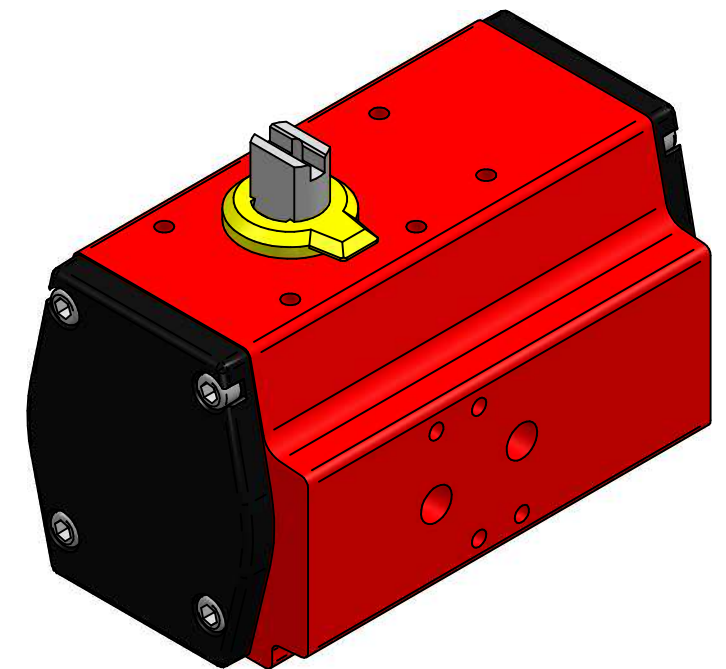

DRAWN	NAME	DATE	SIZE	DWG NO	
				MOTO	11.06.2014
CHECKED	TOCO	dd.mm.yyyy	FILE NAME: REM00001.dft		
ENG APPR	TOCO	dd.mm.yyyy	SCALE: 2:1	REV:	
MGR APPR	TOCO	dd.mm.yyyy	WEIGHT:	SHEET: 1 OF 1	

UNLESS OTHERWISE SPECIFIED DIMENSIONS ARE IN MILLIMETERS AND TOLERANCES ARE +/-0,5

REV	DESCRIPTION	DATE	APPROVED
REVISION HISTORY			

TITLE PNEUMATIC DOUBLE ACTING ACTUATOR RC210 DA