

DETAIL A

Pos	Part name	Material
1	Body	1.4408 (CF8M)
2	Cap	1.4408 (CF8M)
3	Ball	SS316
4	Ball seat	PTFE
5	Stem	SS316
6	Stem Packing	PTFE
7	O-Ring	VITON
8	V-Packing	PTFE
9	Gland	304
10	Washer	301
11	Nut	304
12	Thrust Washer	304
13	Washer	304
14	Handle	304
15	Plastic Cover	Plastic
16	Locking	304
17	Body Gasket	PTFE
18	Bolt	304

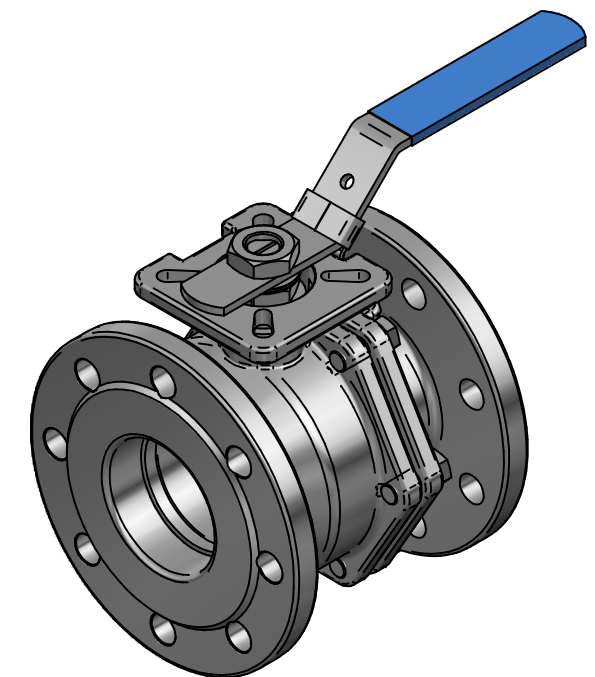

TITLE 2PC BALL VALVE FL. SS316 DN80 CLEANED FOR OXYGEN PN16 FLANGE CONNECTION, WITH SQUARE SPINDLE TORQUE 75N*M F07/F10 17MM

	NAME	DATE	SIZE	DWG NO
DRAWN	EMLA	11.12.2023	A3	QIF-100-OX2-0080
CHECKED	RESO	23.12.2022	FILE NAME: QIF-100-OX2-0080.dft	
ENG APPR	TOCO	dd.mm.yyyy	SCALE: 1:3	REV: 00
MGR APPR	TOCO	dd.mm.yyyy	WEIGHT: 18.9 kg	SHEET: 1 OF 1

UNLESS OTHERWISE SPECIFIED DIMENSIONS ARE IN MILLIMETERS AND TOLERANCES ARE +/-0,5

REV	DESCRIPTION	DATE	APPROVED
00	ISSUED	23.12.22	RESO
REVISION HISTORY			