

# Mariani - fluid control 322 AL/BZ

VALVOLA A SARACINESCA - UNION BONNET – ASTA SALIENTE –  
CUNEO SOLIDO - NI/AL BRONZE - ANSI 150-300

GATE VALVE - UNION BONNET - RISING STEM -  
SOLID WEDGE – NI/AL BRONZE - ANSI 150-300

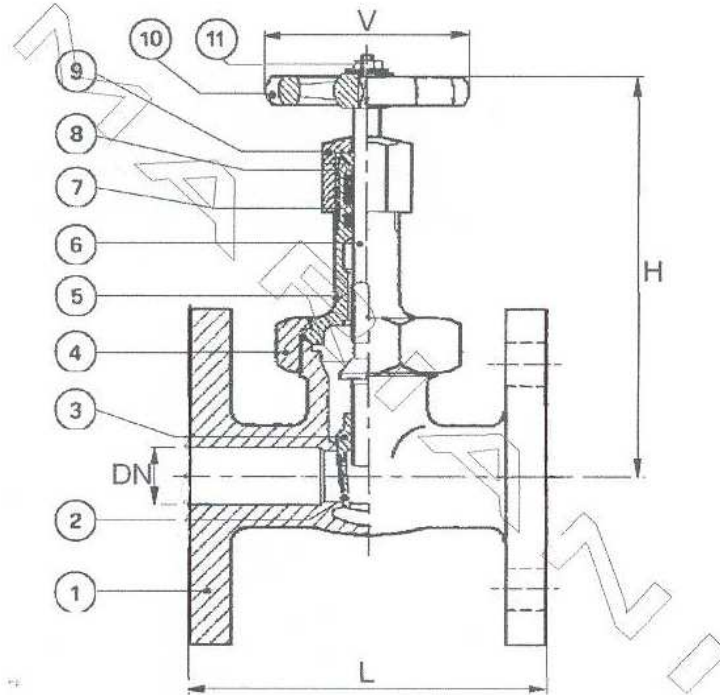

WORKING PRESSURES W.O.G. NON SHOCK	
ANSI 150	350 p.s.i.
ANSI 300	700 p.s.i.

CONFORM TO: BS 5154  
MSS SP 80  
ANSI B16.24  
BACKSEAT

OPTIONAL MATERIAL: B148 C95500  
BS 1400 AB2  
CB 333 G

	DESCRIZIONE	DESCRIPTION	AL/BZ	AL/BZ- MONEL
1	CORPO	BODY	ASTM B148 C95800	ASTM B148 C95800
2	SEDE INTEGRALE	INTEGRAL SEAT	ASTM B148 C95800	ASTM B148 C95800
3	CUNEO	WEDGE	ASTM B148 C95800	MONEL K500
4	CALOTTA	UNION-NUT	ASTM B16	ASTM B16
5	VITONE	BONNET	ASTM B148 C95800	ASTM B148 C95800
6	ASTA	STEM	ASTM B150 C63200	MONEL K500
7	BADERNA	STEM PACKING	GRAPHITE TEFLONED	GRAPHITE TEFLONED
8	PREMISTOPPA	THRUST WASHER	ASTM B16	ASTM B16
9	DADO PREMISTOPPA	GLAND NUT	ASTM B16	ASTM B16
10	VOLANTINO	HANDWHEEL	CARBON STEEL	CARBON STEEL
11	DADO	NUT	ZINC PLATED STEEL	ZINC PLATED STEEL

FLANGED ENDS: ANSI B16.5 (ANSI B16.24 THICKNESS) 150 - 300 FF/RF or DIN 2501 PN 10-16

SIZE	1/2"	3/4"	1"	1 1/4"	1 1/2"	2"
DN	15	23	20	32	40	50
L	100	100	100	145	145	152
H (OPEN)	144	144	145	186	186	235
V	70	70	70	90	90	100
Kg ANSI 150	2.200	2.400	2.600	4.600	4.800	7.300
Kg ANSI 300	2.500	2.700	3.100	6.000	6.300	9.000