

| No. | Part Name | Material | Qty. |
|-----|---------------------|-------------------------------|------|
| 1 | Body | CF8M | 1 |
| 2 | End Cap | CF8M | 2 |
| 3 | Ball | SS 316 | 1 |
| 4 | Stem | SS 316 | 1 |
| 5 | Stem Nut | SS 316 | 2 |
| 6 | Belleville Washer | SUS 301 | 2 |
| 7 | Handle | SS 316 | 1 |
| 8 | Seat | RPTFE | 2 |
| 9 | Gland | SS 316 | 1 |
| 10 | Stem Packing | PTFE | 2 |
| 11 | Stem Seal | RPTFE | 1 |
| 12 | Lock Saddle | SS 316 | 1 |
| 13 | Joint Gasket | PTFE | 2 |
| 14 | Bolt | SS 316 | 4 |
| 15 | Stop Pin | SS 316 | 1 |
| 16 | Handle Sleeve | Vinyl | 1 |
| 17 | Bolt Nut | SS 316 | 4 |
| 18 | Stem Washer | SS 316 | 1 |
| 19 | Stem Packing | 25% Glass Fiber filled + PTFE | 1 |
| 20 | Locking Device | SS 316 | 1 |
| 21 | Pin Nut | SS 316 | 1 |
| 22 | Washer | SS 316 | 1 |
| 23 | Antistatic - Device | SS 316 | 2 |
| 24 | O-RING | VITON | 1 |

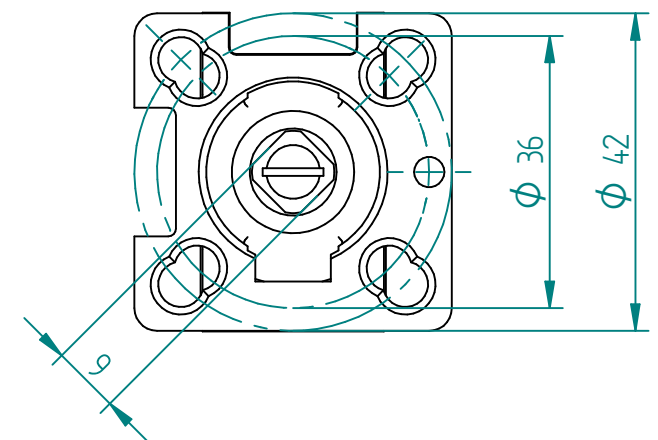

| | | NAME | DATE | SIZE | DWG NO |
|----------|------|------------|-------------------------|---------------|--------|
| DRAWN | MOTO | 11.04.2018 | A3 | MAR00163 | |
| CHECKED | TOCO | 11.04.2018 | FILE NAME: MAR00163.dft | | |
| ENG APPR | TOCO | 11.04.2018 | SCALE: 1:1,25 | REV: | |
| MGR APPR | TOCO | 11.04.2018 | WEIGHT: 0,82 kg | SHEET: 1 OF 1 | |

UNLESS OTHERWISE SPECIFIED DIMENSIONS ARE IN MILLIMETERS AND TOLERANCES ARE +/-0,5

| REV | DESCRIPTION | DATE | APPROVED |
|------------------|-------------|------|----------|
| REVISION HISTORY | | | |

TITLE BALL VALVE MARS 88-30
3-PIECE 1/2" PN125 BW