

No.	Part Name	Material	Qty.
1	Body	Ductile Iron	1
2	Disc	Aluminum Bronze	1
3	Stem	Stainless Steel	1
4	Seat	BUNA-N	1

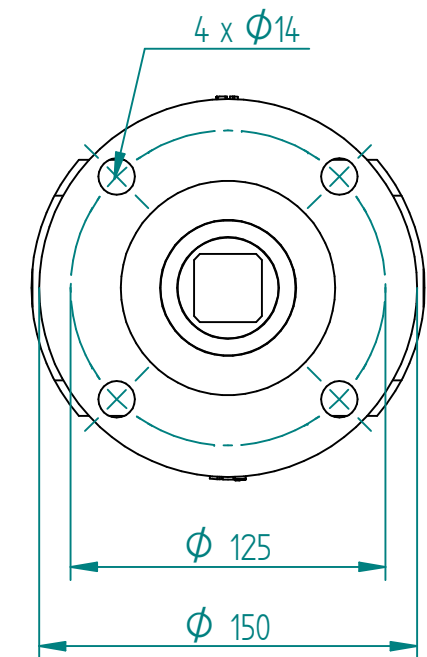

1:3 Top Plate

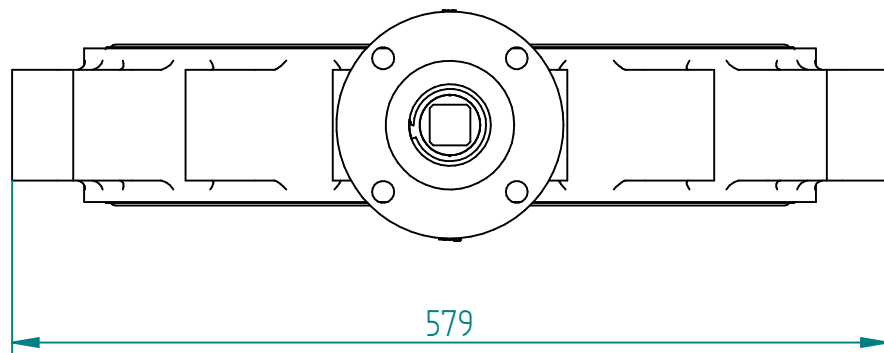

		NAME	DATE	SIZE	DWG NO	UNLESS OTHERWISE SPECIFIED DIMENSIONS ARE IN MILLIMETERS AND TOLERANCES ARE +/-0,5
DRAWN		MOTO	06.08.2014	A3	BRA16400	
CHECKED		TOCO	dd.mm.yyyy	FILE NAME: BRA16400.dft		
TITLE		TOCO	dd.mm.yyyy	SCALE: 1:5	REV:	
BUTTERFLY VALVE BRAY S31/35U U/C DISC COCENTRIC LUG 16" PN10		MGR APPR	TOCO	dd.mm.yyyy	WEIGHT: 75,0 kg	SHEET: 1 OF 1

REV	DESCRIPTION	DATE	APPROVED
REVISION HISTORY			