

DETAIL A

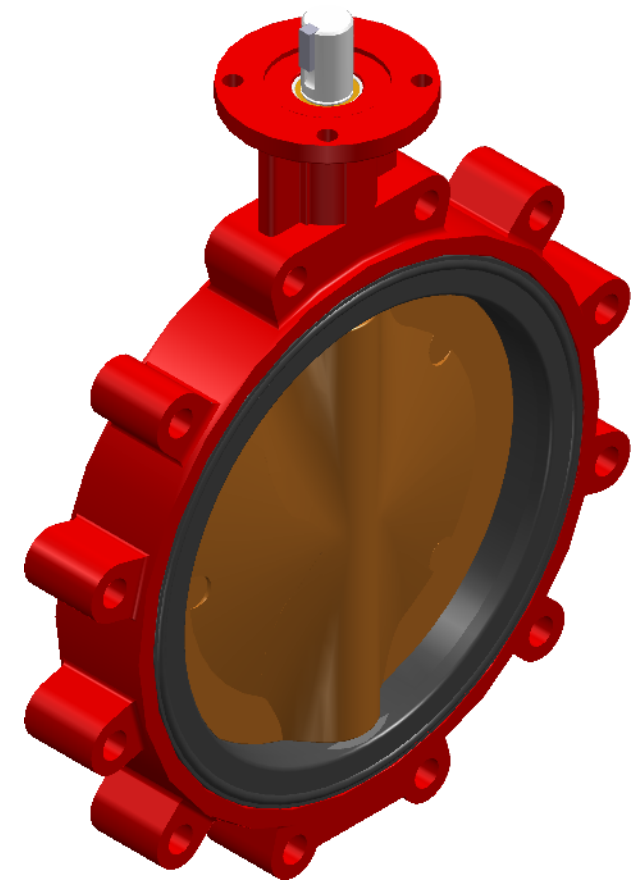

TITLE BFV S31/35V 14" 10BAR ANSI150 LUG
CONC. DI/ALBR/416/NBR KW29X10 F12
BARE SHAFT

	NAME	DATE	SIZE	DWG NO
DRAWN	RAGA	15.03.2024	A3	BRA00213B
CHECKED	TOCO	dd.mm.yyyy	FILE NAME: BRA00213B.dft	
ENG APPR	TOCO	dd.mm.yyyy	SCALE: 1:5	REV: 00
MGR APPR	TOCO	dd.mm.yyyy	WEIGHT: 52 kg	SHEET: 1 OF 1

UNLESS OTHERWISE
SPECIFIED
DIMENSIONS ARE IN
MILLIMETERS
AND TOLERANCES ARE
+/-0,5

REV	DESCRIPTION	DATE	APPROVED
REVISION HISTORY			